



AirSAS

Inflatable, easy to **transport**,
simple and **fast** installation





EXAMPLE OF A VERTICAL MODEL:
 - For people in a seated position
 - Area of application: air transport



EXAMPLE OF A HORIZONTAL MODEL:
 - For people in a lying position
 - Areas of application: ambulance, emergency services

A mobile and flexible SAS, adapted to your needs

The structure is fully inflatable and the walls in calendered PVC Crystal guarantee perfect transparency even in daylight. Quick and easy installation and implementation even in the tight space. Great flexibility in use and manipulation, compatible and adaptable to any installation. Effective barrier against pollutants and contaminants.



Simple and quick installation
 Inflation time: 5 minutes



Easy to carry
 everywhere thanks to the carrying case



Lightweight and great flexibility
 in use and handling



Effective barrier
 against pollutants and contaminants



Compatible
 with cleaning and decontamination agents of surface

Areas of application



NUCLEAR



HOSPITAL



AMBULANCE



AIR TRANSPORT



MILITARY



NATIONAL POLICE FORCE



POLICE



EMERGENCY SERVICES

Products Customization

Our SAS model formats are adaptable to your needs

Materials

PVC PVC CRISTAL

EXAMPLES OF REALIZATIONS

Cover - Material

- A - Translucent polyvinyl chloride azured (PVC M1 200 μ)
- B - Translucent polyvinyl chloride azured (PVC Cristal 150 μ)
- C - Translucent polyvinyl chloride azured (PVC TA 300 μ)
- D - White separable zipper 150 cm

Inflatable structure - Material

- 1 - Translucent polyvinyl chloride azured (PVC TA 500 μ)
- 2 - PVC inflation valve
- 3 - Pressure Relief Valve 0.07 bar with G 3/4" pipe thread

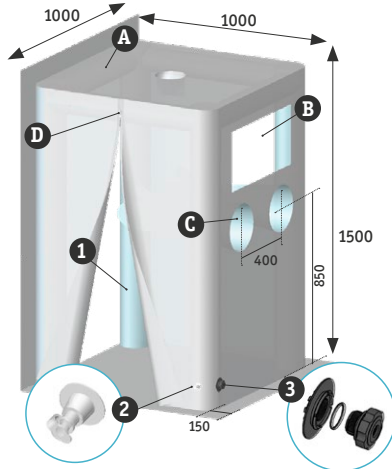

Vertical model for people in a sitting position

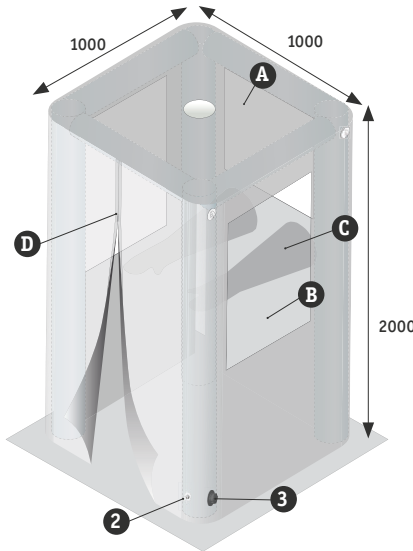
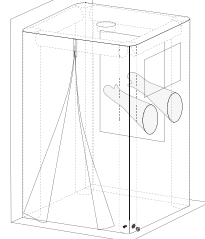

Vertical model for people in standing position

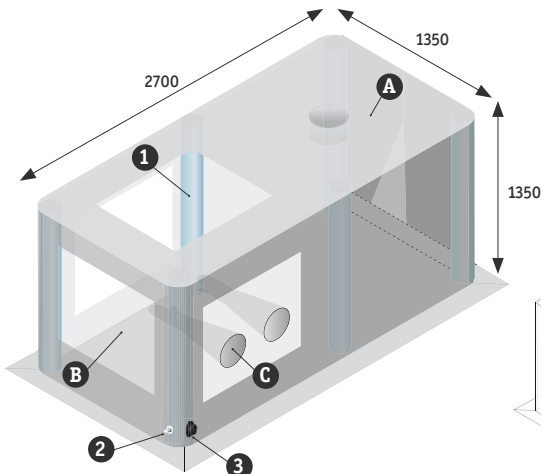
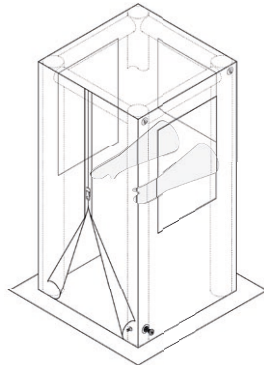

Horizontal model for people in lying position or to hold devices

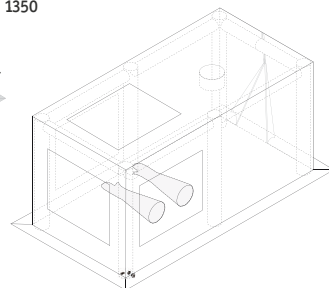

CARRYING CASE



The compact transport bag provides good protection of the airlock and facilitates transport. An inflator is also offered.

- Total weight (airlock, inflator, bag): about 6,5 kg
- Dimensions of the folded airlock: 550 x 450 x 200 mm
- Dimensions of the inflator: 300 x 250 x 80 mm

PRODUCT BENEFITS

- An SAS adaptable to your needs and customized thanks to a wide choice of options: dimensions, number of sleeves, accessories ...
- Walls in calendered PVC Cristal guarantee perfect transparency (even in daylight).
- Quick and easy installation and implementation even in the tight space.
- Very light and easy to transport thank to the structure is fully inflatable
- Effective barrier against pollutants and contaminants
- A transport bag and an inflator are supplied with the airlock

From the study to the realized part of **the Inflatables SAS**

From the start of your project, PiercanTech brings you the right solution, via a controlled process - study, manufacturing, control - where quality is the object of all our vigilance.

THE STUDY



• Office of Studies

Analyzes your requests and accompanies you in the search for the most suitable solution including choice of material, product development, and prototyping.

• Economic Optimization

The study of solutions adapted to your needs integrates both quality factors, time and production costs, thus facilitating economic optimization of your project.

MANUFACTURING



• The Cut

Scissors with circular blades and vibrating blades are used for semi-automatic end cutting (unit cut to pattern, mattress format or a template).

• The Weld

Made by high frequency welding which guarantees a perfect seal of the assemblies.

• Properties

Compatible with cleaning agents, decontamination and disinfection.

CONTROL IN THREE STEPS



1 • Prior inspection of raw materials and tools with verification of design dimensions via our production management software.

2 • Control during the production of physico-chemical parameters by the quality control laboratory and production parameters by the operators.

3 • Control of the finished product

- Sealing control
- Weld control
- Marking allowing the identification of the controlled part for a total traceability.

PIERCAN around the world



Piercan US Office • Factory
San Diego

USA



Piercan Commercial Management • Factory
Paris

France



Piercan Headquarter • Factory
Normandy

France

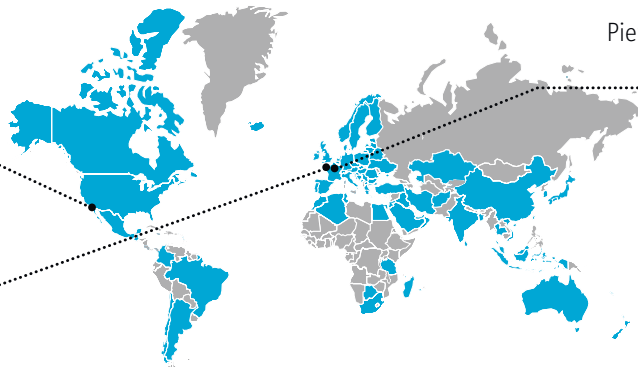

■ Piercan products are sold in more than 50 countries



A QUESTION OR IN NEED OF INFORMATION?

Please do not hesitate to contact our sales team by phone or email.
Piercan's services and products are only one call away:

☎ **Telephone** +33 (0)1 45 88 66 27 (FR)
+1 (760) 599 4543 (USA)

✉ **E-mail** piercan@piercan.com



PIERCAN FRANCE

Impasse des Macareux
14520 Port-en-Bessin-Huppain - FRANCE
T +33 (0)1 45 88 66 27
piercan@piercan.com | piercan.com

PIERCAN USA, INC.

160 Bosstick Blvd
92069 San Marcos, CA - USA
T +1 (760) 599 4543
piercan@piercan.com | piercan.com

